

## Flat Profile Mullion Seal Installation Instructions

April 4, 2024

1. Prior to installing partition, cut Mullion Seal to length. Portions may be butted together.
2. Do not remove release liner from Mullion Seal until ready for installation. Clean face of mullion of dust and dirt; alcohol wipes are recommended for best performance.
3. Remove release liner over adhesive from side facing mullion **only**. *Take care to remove release liner without peeling the adhesive from the rubber.* Firmly set in place (Fig. 1). A soft rubber brayer (roller) is recommended; bond will increase with pressure and time.
4. Attach gypsum board(s) to the web of the end stud. A metal end cap (ex.: Gordon Series 910) is also recommended for best bond so adhesive does not strip paper from the gypsum board when stressed.
5. Remove release liner from side facing partition, place in position (Fig. 2) and set firmly in place applying continuous pressure. A brayer is recommended.
  - a. As an alternative method, set prefabricated portion of partition (Fig. 3). Include double studs for additional restraint of mullion deflection (hi-rise applications).
6. Continue to construct remainder of partition.

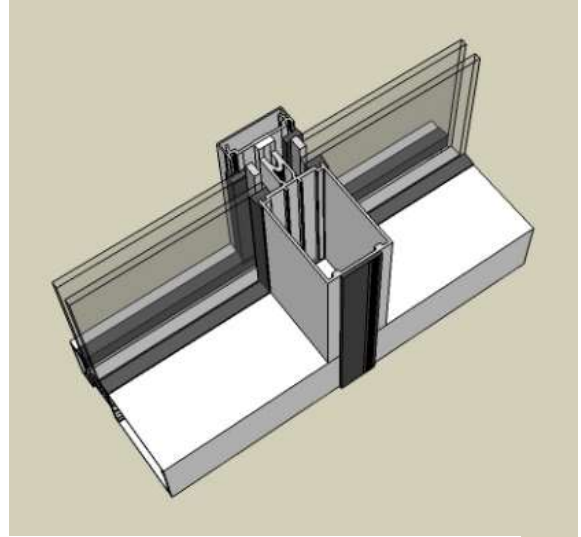

Figure 1: Adhere Mullion Seal to Mullion

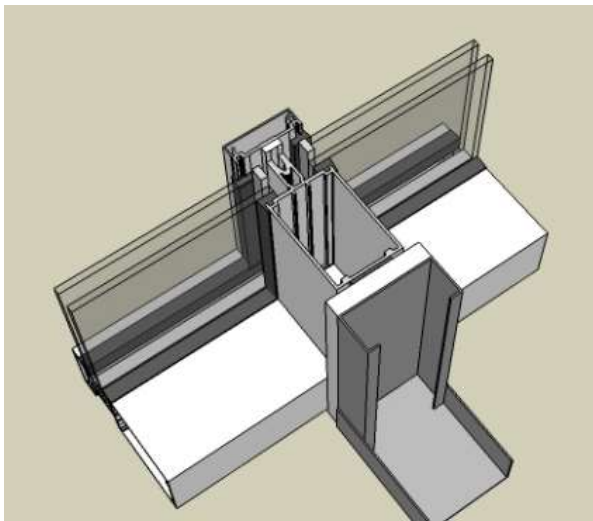

Figure 2: Install end stud with board attached

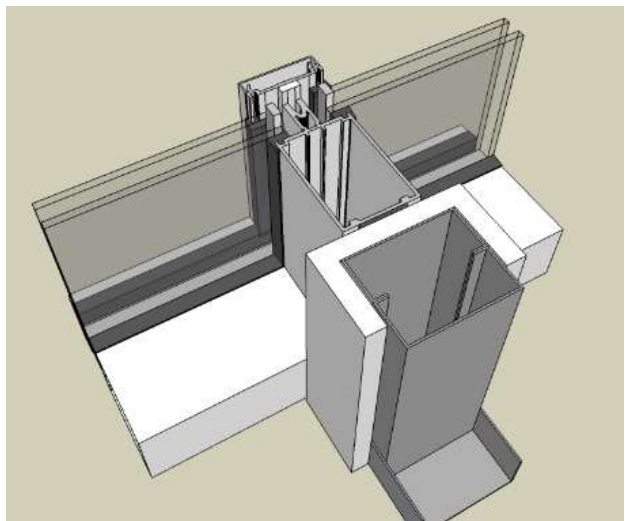

Figure 3: Alternate: Install finished portion of partition