

Details for Acoustic Sleeper™ Type C Installation: Frame Construction

Inverted Plan of Strips with Pads:

Wood Lath Strips, 5/16" thick x 1-1/2" wide.

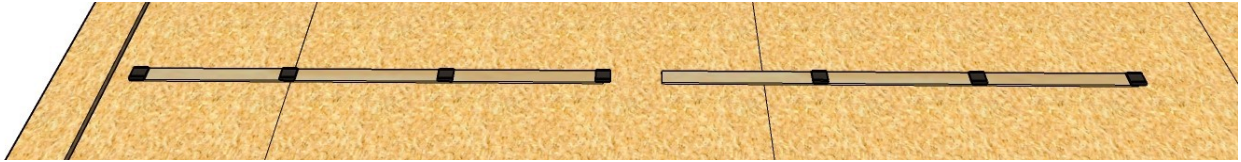

- Fig. 1: Staple STC Acoustic Sleeper™ pads on 5/16" thick by 1-1/2" wide wood lattice strips at 16" o.c. minimum.
 - Install pad at leading and trailing edges of strip flush to end of where strip butts against bearing strips.
 - Omit pad at leading edge of strip where strip bears on projected pad at trailing edge of adjacent strip.
 - Overlap pad on trailing end.

Partitions in Wood Framing

Typical Section Details for partitions in wood frame

- Fig. 2: Typical detail for load-bearing partitions, shear walls, and fire-resistance-rated walls. Place a 9/16" continuous plywood or OSB bearing strip under partition.

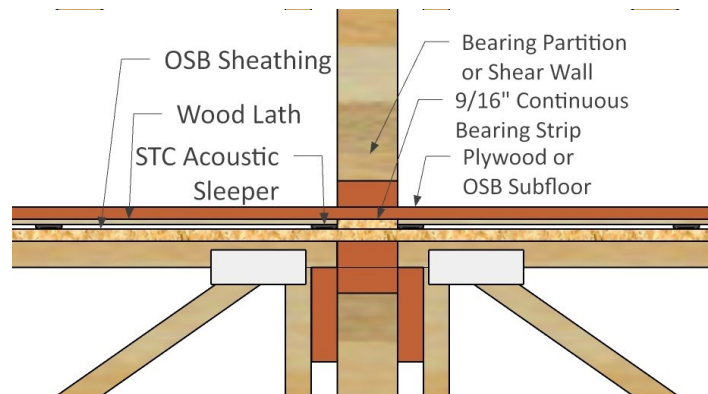

- Fig. 3: Typical detail for non-load-bearing partitions. No plywood or OSB bearing strip required unless partition is fire-resistance-rated. Avoid loads on partitions.

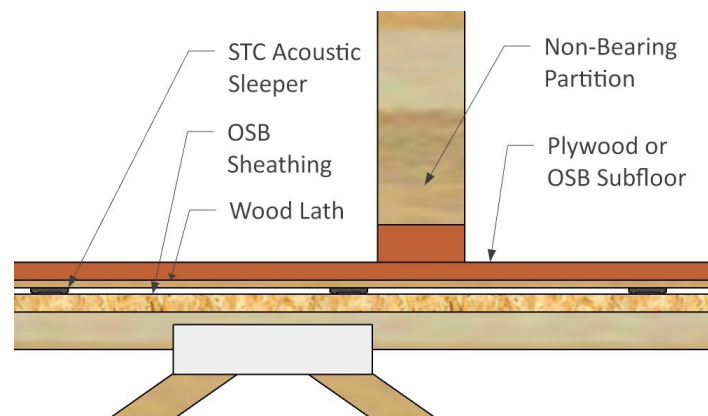

August 1, 2020
Paul L. Battaglia